



MAX
MIN
CHLORIDE

CHLORIDE

FAURE - X
Enclosed
Cells
FCP & FHP



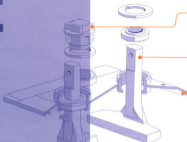

• **Vent Plugs**

Designed to eliminate spray but give free exit of gases.

• **Cell Pillars & Connectors**

Each one designed specifically for the job. Give minimum resistance – maximum current flow.

• **Cell Lids**

Opaque SAN. Complete seal with container means no leakage.

• **Negative Plates**

Pasted grids. Provide perfect balance with the positive to give maximum performance.

• **Separators**

Double separation between adjacent plates.

Glass wool mat.

Sintered microporous p.v.c. (Ensures retention of positive active material while affording minimum internal resistance)

• **Positive Plates**

Alloy grids with Selenium and finer oxides bring longer life and higher capacity.

• **Cell Containers**

Transparent SAN. Electrolyte level and cell condition clearly seen. Good electrolyte reserve to reduce periods of maintenance.

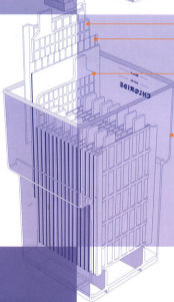

Designed for all standby duties, including power stations, telephone exchanges, telecommunications and emergency lighting.

Noteworthy advantages of these cells are:

- a simple hydrometer reading indicates the state of charge, facilitating inspection, test and maintenance.
- increased capacity, combined with decreased volume and weight.
- life expectancy of around 15 years.
- float charge operation, always ready for use.

Design Features

POSITIVE PLATES are constructed of 5mm thick industrial paste grid alloys, in a long-life paste formulation, suitable for float charge and cycling applications.

NEGATIVE PLATES are of industrial pasted grid construction, for balanced performance and life.

SEPARATORS, of glass fibre matting and Porvic 2 (sintered microporous PVC), which form a complete diaphragm between the plates. This method of dual separation ensures retention of positive active material while affording minimum internal resistance.

Technical Details

VOLTAGE

The nominal voltage is 2 volts per cell, i.e. a nominal 110V battery will have 55 cells. On discharge, the recommended final voltage at which the discharge should be terminated depends on the discharge rate. For example, discharge curves indicate that the final voltage for the three hour rate of discharge is 1,8 volts.

It is not recommended to continue discharging the cells once the final voltage has been reached as the voltage will fall away at an increasing rate with minimal gain of discharge duration and the risk of over-discharge.

CAPACITY

The capacity of these cells is normally rated at the 10-hour rate of discharge although the capacity which can be taken from a cell will vary with the discharge rate, as indicated in the capacity table. Capacity is also affected by temperature.

FLOAT CHARGING

As these cells are designed for standby applications they should be float charged to ensure that they remain fully charged, ready for instant use, at all times. We recommend a float charge setting of 2,25 volts per cell at 25°C.

VISUAL INSPECTION CONTAINERS, moulded from transparent styrene acrylonitrile (SAN), ensure optimum transparency and very high insulating qualities which eliminate the need for separate cell insulators.

CELL LIDS are moulded from opaque SAN permanently sealed to the container.

VENT PLUGS are of a special design which effectively returns all acid spray to the cell, but allows free exit of oxygen and hydrogen gases.

A simple hydrometer reading indicates the state of charge. A fully charged cell will have a specific gravity of 1,250.

RECHARGING

The cell's ampere hour efficiency is 90%. To fully recharge the cells the amount of charge required is equal to the amount of discharge in ampere hours plus 11%.

INSTALLATION

These cells can be connected either edge to edge or face to face. The standard method of connection is to follow the shortest distance between two terminals.



ENCLOSED CELLS FCP & FHP



FAURE-X, CAPACITIES, WEIGHTS AND DIMENSIONS

Type	Capacity in ampere-hours when discharged in			Initial Charge current Amps	Weight		Approx. quantity of acid Rees	External dimensions of cell container			Overall height of cells mm	Centres of cells mm	Width single row storage or stand mm	Width double row storage or stand mm
	10 hours	3 hours	1 hour		Cell empl. litres	Acid only 1,250 kg		Length mm	Width mm	Height mm				
	1.85	1.80	1.75		Kg	Kg								
FCP 5	64	46	32	6	11.5	6.7	5.4	134	250	349	423	140	400	710
FCP 7	96	69	48	7	12.9	8.4	5.2	134	250	349	423	140	400	710
FCP 9	128	92	64	9	14.2	9.1	5.0	134	250	349	423	140	400	710
FCP 11	160	115	80	11	15.6	9.9	4.8	134	250	349	423	140	400	710
FCP 13	192	138	96	13	17.0	10.6	4.6	134	250	349	423	140	400	710
FCP 15	224	161	112	15	18.4	11.3	4.4	172	250	349	423	178	400	710
FCP 17	256	184	128	18	20.2	12.1	4.2	172	250	349	423	178	400	710
FCP 19	288	207	144	20	22.0	12.9	4.0	172	250	349	423	178	400	710
FCP 21	320	230	160	22	23.8	13.7	3.8	210	250	349	423	209	406	662
FCP 23	360	253	176	25	26.7	14.6	3.6	210	250	349	423	209	406	662
FCP 25	384	276	192	27	28.6	15.4	3.4	248	250	349	423	209	406	662
FCP 27	416	299	208	29	30.5	16.2	3.2	248	250	349	423	209	406	662
FCP 29	448	322	224	31	32.4	17.0	3.0	286	250	349	423	209	406	662
FCP 31	480	345	240	34	34.3	17.8	2.8	286	250	349	423	209	406	662
FCP 33	512	368	256	36	36.2	18.6	2.6	286	250	349	423	209	406	662
FCP 35	544	391	272	38	38.1	19.4	2.4	362	250	349	423	209	406	662
FCP 37	576	414	288	40	40.0	20.2	2.2	362	250	349	423	209	406	662
FCP 39	608	437	304	42	41.9	21.0	2.0	362	250	349	423	209	406	662
FCP 41	640	460	320	44	43.8	21.8	1.8	362	250	349	423	209	406	662
FCP 43	672	483	336	47	45.7	22.6	1.6	362	250	349	423	209	406	662
FHP 15	917	648	412	52	80.0	34.8	26.2	230	368	592	682	256	376	969
FHP 17	1050	741	470	60	94.2	39.9	27.5	230	368	592	682	256	376	969
FHP 19	1180	834	529	67	108.4	45.1	26.8	230	368	592	682	256	376	969
FHP 21	1310	927	588	75	122.6	50.3	26.0	230	368	592	682	256	376	969
FHP 23	1440	1020	647	82	136.8	47.1	26.2	306	368	592	682	330	376	969
FHP 25	1570	1113	706	90	151.0	45.2	27.4	306	368	592	682	330	376	969
FHP 27	1700	1206	764	97	165.2	43.3	26.7	306	368	592	682	330	376	969
FHP 29	1830	1299	823	105	179.4	41.4	26.9	306	368	592	682	330	376	969
FHP 31	1970	1382	882	112	193.6	43.5	26.0	306	368	592	682	330	376	969
FHP 33	2130	1482	941	120	207.8	41.6	26.1	362	368	592	682	394	360	909
FHP 35	2230	1575	1000	127	212.0	42.4	26.2	362	368	592	682	394	360	909
FHP 37	2360	1668	1058	135	226.2	41.5	26.3	362	368	592	682	394	360	909
FHP 39	2490	1761	1117	142	240.4	40.6	26.4	362	368	592	682	394	360	909
FHP 41	2620	1854	1176	150	254.6	41.7	26.5	362	368	592	682	394	360	909
FHP 43	2750	1947	1235	157	268.8	42.8	26.6	362	368	592	682	394	360	909
FHP 45	2880	2040	1294	165	283.0	43.9	26.7	362	368	592	682	394	360	909
FHP 47	3010	2133	1353	172	297.2	45.0	26.8	430	368	592	682	394	435	1099
FHP 49	3140	2226	1411	180	311.4	46.1	26.9	430	368	592	682	394	435	1099
FHP 51	3280	2319	1470	187	325.6	47.2	27.0	430	368	592	682	394	435	1099
FHP 53	3410	2409	1529	195	339.8	48.3	27.1	509	368	592	682	394	510	1249
FHP 55	3540	2502	1588	202	354.0	49.4	27.2	509	368	592	682	394	510	1249
FHP 57	3670	2595	1646	210	368.2	50.5	27.3	509	368	592	682	394	510	1249
FHP 59	3800	2688	1705	217	382.4	51.6	27.4	509	368	592	682	394	510	1249
FHP 61	3930	2781	1764	225	396.6	52.7	27.5	509	368	592	682	394	510	1249
FHP 63	4060	2874	1823	232	410.8	53.8	27.6	509	368	592	682	394	510	1249
FHP 65	4190	2967	1882	240	425.0	54.9	27.7	585	368	592	682	394	586	1401
FHP 67	4320	3060	1940	247	439.2	56.0	27.8	585	368	592	682	394	586	1401
FHP 69	4450	3153	1999	255	453.4	57.1	27.9	585	368	592	682	394	586	1401

The length of a stand is $n \times$ cell centre where n is the number of cells.

Flat Plate Cells: Type FCP & FHP

Constant Current Discharge Rates at 25° Centigrade

Current (in amps) to 1.85 - 1.80 Volts per Cell

Cell Type	5 min	10 min	15 min	20 min	30 min	45 min	1 hour	2 hour	3 hour	5 hour	6 hour	8 hour	10 hour	Volts/Cell
FCP-5	48.4	48.4	45.0	43.0	39.7	34.7	29.3	17.4	14.2	10.4	9.1	7.5	6.4	
FCP-7	72.8	70.0	65.6	61.2	56.6	50.1	43.5	26.1	21.3	15.8	13.8	11.3	9.6	
FCP-9	85.3	81.8	76.4	72.0	67.6	61.1	54.5	34.8	28.4	20.8	18.2	15.1	12.8	
FCP-11	117	112	106	102.0	97.5	91.0	84.4	51.5	42.2	31.1	27.7	22.7	19.2	
FCP-13	138	132	127	123	118.0	112.5	107.0	67.3	55.9	41.1	35.7	28.7	23.7	
FCP-15	158	150	143	139	133	127.5	122.0	76.2	63.8	47.7	41.3	33.8	27.4	
FCP-17	177	170	164	159	154	148.5	143.0	86.4	74.8	56.4	49.0	39.7	32.5	
FCP-19	187	181	176	171	166	161	156	111	97.3	73.3	64.8	52.8	42.8	
FCP-21	214	205	198	193	187.5	182.0	176.5	128	112	83.3	73.8	59.8	48.8	
FCP-23	230	220	213	208	202.5	197.0	191.5	136	123	92.7	82.2	67.2	55.2	
FCP-25	246	235	228	223	217.5	212.0	206.5	148	134	104	92.2	76.2	62.2	
FCP-27	262	250	243	238	232.5	227.0	221.5	167	149	113	102.3	83.8	69.8	
FCP-29	278	265	258	253	247.5	242.0	236.5	185	165	122	109.4	93.8	77.8	
FCP-31	293	279	272	267	261.5	256.0	250.5	203	181	132	116.4	103.8	85.8	
FCP-33	309	294	287	282	276.5	271.0	265.5	221	197	143	125.4	113.8	93.8	
FCP-35	325	308	301	296	290.5	285.0	279.5	239	214	154	134.4	123.8	101.8	
FCP-37	340	322	315	310	304.5	299.0	293.5	257	230	165	143.4	132.8	110.8	
FCP-39	356	337	330	325	319.5	314.0	308.5	275	246	176	152.4	141.8	118.8	
FCP-41	371	351	344	339	333.5	328.0	322.5	293	262	187	161.4	150.8	126.8	
FCP-43	387	366	359	354	348.5	343.0	337.5	311	278	198	170.4	159.8	134.8	
FCP-45	402	380	373	368	362.5	357.0	351.5	329	294	209	179.4	168.8	142.8	
FCP-47	418	395	388	383	377.5	372.0	366.5	347	310	220	188.4	177.8	150.8	
FCP-49	433	410	403	398	392.5	387.0	381.5	365	326	230	197.4	186.8	158.8	
FCP-51	449	425	418	413	407.5	402.0	396.5	383	342	241	206.4	195.8	166.8	
FCP-53	464	440	433	428	422.5	417.0	411.5	401	358	251	215.4	204.8	174.8	
FCP-55	480	455	448	443	437.5	432.0	426.5	419	374	261	224.4	213.8	182.8	
FCP-57	495	470	463	458	452.5	447.0	441.5	437	390	271	233.4	222.8	190.8	
FCP-59	511	485	478	473	467.5	462.0	456.5	455	406	281	242.4	231.8	200.8	
FCP-61	526	500	493	488	482.5	477.0	471.5	473	416	291	251.4	240.8	208.8	
FCP-63	542	515	508	503	497.5	492.0	486.5	491	426	301	260.4	249.8	216.8	
FCP-65	557	530	523	518	512.5	507.0	501.5	509	436	311	269.4	258.8	224.8	
FCP-67	573	545	538	533	527.5	522.0	516.5	525	446	321	278.4	267.8	232.8	
FCP-69	588	560	553	548	542.5	537.0	531.5	541	456	331	287.4	276.8	240.8	
FCP-71	604	575	568	563	557.5	552.0	546.5	555	466	341	296.4	285.8	248.8	
FCP-73	620	590	583	578	572.5	567.0	561.5	571	476	351	305.4	294.8	256.8	
FCP-75	635	605	598	593	587.5	582.0	576.5	585	486	361	314.4	303.8	264.8	
FCP-77	651	620	613	608	602.5	597.0	591.5	599	496	371	323.4	312.8	272.8	
FCP-79	666	635	628	623	617.5	612.0	606.5	615	506	381	332.4	321.8	280.8	
FCP-81	682	650	643	638	632.5	627.0	621.5	631	516	391	341.4	330.8	288.8	
FCP-83	697	665	658	653	647.5	642.0	636.5	645	526	401	350.4	339.8	296.8	
FCP-85	713	680	673	668	662.5	657.0	651.5	661	536	411	359.4	348.8	304.8	
FCP-87	728	695	688	683	677.5	672.0	666.5	675	546	421	368.4	357.8	312.8	
FCP-89	744	710	703	698	692.5	687.0	681.5	691	556	431	377.4	366.8	320.8	
FCP-91	759	725	718	713	707.5	702.0	696.5	705	566	441	386.4	375.8	328.8	
FCP-93	775	740	733	728	722.5	717.0	711.5	721	576	451	395.4	384.8	336.8	
FCP-95	790	755	748	743	737.5	732.0	726.5	735	586	461	404.4	393.8	344.8	
FCP-97	806	770	763	758	752.5	747.0	741.5	751	596	471	413.4	402.8	352.8	
FCP-99	821	785	778	773	767.5	762.0	756.5	765	606	481	422.4	411.8	360.8	
FCP-101	837	800	793	788	782.5	777.0	771.5	781	616	491	431.4	420.8	368.8	
FCP-103	852	815	808	803	797.5	792.0	786.5	795	626	501	440.4	429.8	376.8	
FCP-105	868	830	823	818	812.5	807.0	801.5	811	636	511	449.4	438.8	384.8	
FCP-107	883	845	838	833	826.5	821.0	815.5	825	646	521	458.4	447.8	392.8	
FCP-109	899	860	853	848	841.5	836.0	830.5	841	656	531	467.4	456.8	400.8	
FCP-111	914	875	868	863	856.5	851.0	845.5	855	666	541	476.4	465.8	408.8	
FCP-113	930	890	883	878	870.5	865.0	859.5	871	676	551	485.4	474.8	416.8	
FCP-115	945	905	898	893	884.5	879.0	873.5	883	686	561	494.4	483.8	424.8	
FCP-117	961	920	913	908	903.5	898.0	892.5	903	696	571	503.4	492.8	432.8	
FCP-119	976	935	928	923	917.5	912.0	906.5	917	706	581	512.4	501.8	440.8	
FCP-121	992	950	943	938	932.5	927.0	921.5	931	716	591	521.4	510.8	448.8	
FCP-123	1007	965	958	953	946.5	941.0	935.5	945	726	601	530.4	519.8	456.8	
FCP-125	1023	980	973	968	961.5	956.0	950.5	961	736	611	539.4	528.8	464.8	
FCP-127	1038	995	988	983	976.5	971.0	965.5	975	746	621	548.4	537.8	472.8	
FCP-129	1054	1010	1003	998	991.5	986.0	980.5	991	756	631	557.4	546.8	480.8	
FCP-131	1069	1025	1018	1013	1006.5	1001.0	995.5	1005	766	641	566.4	555.8	488.8	
FCP-133	1085	1040	1033	1028	1020.5	1015.0	1009.5	1019	776	651	575.4	564.8	496.8	
FCP-135	1100	1055	1048	1043	1034.5	1029.0	1023.5	1033	786	661	584.4	573.8	504.8	
FCP-137	1116	1070	1063	1058	1048.5	1043.0	1037.5	1047	796	671	593.4	582.8	512.8	
FCP-139	1131	1085	1078	1073	1062.5	1057.0	1051.5	1061	806	681	602.4	591.8	520.8	
FCP-141	1147	1100	1093	1088	1076.5	1071.0	1065.5	1075	816	691	611.4	600.8	528.8	
FCP-143	1162	1115	1108	1103	1090.5	1085.0	1079.5	1085	826	701	620.4	609.8	536.8	
FCP-145	1178	1130	1123	1118	1104.5	1099.0	1093.5	1099	836	711	629.4	618.8	544.8	
FCP-147	1193	1145	1138	1133	1118.5	1113.0	1107.5	1113	846	721	638.4	627.8	552.8	
FCP-149	1209	1160	1153	1148	1132.5	1127.0	1121.5	1127	856	731	647.4	636.8	560.8	
FCP-151	1224	1175	1168	1163	1146.5	1141.0	1135.5	1141	866	741	656.4	645.8	568.8	
FCP-153	1240	1190	1183	1178	1160.5	1155.0	1149.5	1155	876	751	665.4	654.8	576.8	
FCP-155	1255	1205	1198	1193	1174.5	1169.0	1163.5	1169	886	761	674.4	663.8	584.8	
FCP-157	1271	1220	1213	1208	1188.5	1183.0	1177.5	1183	896	771	683.4	672.8	592.8	
FCP-159	1286	1235	1228	1223	1202.5	1197.0	1191.5	1197	906	781	692.4	681.8	600.8	
FCP-161	1302	1250	1243	1238	1216.5	1211.0	1205.5	1211	916	791	701.4	690.8	608.8	
FCP-163	1317	1265	1258	1253	1230.5	1225.0	1219.5	1225	926	801	710.4	699.8	616.8	
FCP-165	1333	1280	1273	1268	1244.5	1239.0	1233.5	1239	936	811	719.4	708.8	624.8	
FCP-167	1348	1295	1288	1283	1258.5	1253.0	1247.5	1253	946	821	728.4	717.8	632.8	
FCP-169	1364	1310	1303	1298	1272.5	1267.0	1261.5	1267	956	831	737.4	726.8	640.8	
FCP-171	1379	1325	1318	1313	1286.5	1281.0	1275.5	1281	966	841	746.4	735.8	648.8	
FCP-173	1395	1340	1333	1328	1300.5	1295.0	1289.5	1295	976	851	755.4	744.8	656.8	
FCP-175	1410	1355	1348	1343	1314.5	1309.0	1303.5	1309	986	861	764.4	753.8	664.8	
FCP-177	1426	1370	1363	1358	1328.5	1323.0	1317.5	1323	996	871	773.4	762.8	672.8	
FCP-179	1441	1385	1378	1373	1342.5	1337.0	1331.5	1337	1006					

Flat Plate Cells: Type FCP & FHP
Constant Current Discharge Rates at 25° Centigrade

Current (in amps) to 1.75 – 1.70 Volts per Cell

Cell Type	5 min	10 min	15 min	20 min	30 min	45 min	1 hour	2 hour	3 hour	5 hour	6 hour	8 hour	10 hour	Volts/Cell
FCP 7	75.0	63.2	55.8	49.8	43.5	37.8	32.0	26.2	20.3	15.3	12.7	9.4	7.5	6.4
FCP 7	136	98.0	90.3	74.2	65.8	56.8	48.0	40.0	33.0	25.0	18.1	14.1	11.3	9.6
FCP 7	180	128	120	98.8	87.2	75.6	64.0	53.0	43.0	32.0	24.0	18.8	15.1	12.8
FCP 15	172	129	118	101	90.0	79.0	68.0	58.0	48.0	37.0	28.0	21.0	16.8	14.1
FCP 15	236	172	158	132	120	108	96.0	84.0	72.0	60.0	48.0	36.0	28.0	19.2
FCP 15	328	236	220	188	172	156	140	124	108	92.0	76.0	60.0	48.0	32.4
FCP 15	440	328	312	260	240	220	200	176	152	128	104	80.0	64.0	43.2
FCP 15	588	440	420	352	328	304	280	248	224	184	144	112	88.0	57.6
FCP 15	788	588	568	472	440	408	376	336	304	256	208	160	128	80.0
FCP 15	1068	788	768	640	600	560	520	456	416	352	288	224	176	112.0
FCP 15	1440	1068	1048	880	840	792	744	640	592	504	408	320	256	144.0
FCP 15	1920	1440	1420	1200	1160	1120	1080	928	880	752	608	480	384	192.0
FCP 15	2520	1920	1900	1600	1560	1520	1480	1280	1240	1056	864	688	544	252.0
FCP 15	3240	2520	2500	2080	2040	1980	1940	1664	1624	1392	1136	912	720	324.0
FCP 15	4080	3240	3220	2640	2600	2560	2520	2112	2072	1760	1456	1168	928	408.0
FCP 15	5040	4080	4060	3360	3320	3280	3240	2688	2648	2240	1888	1536	1216	504.0
FCP 15	6120	5040	5020	4080	4040	4000	3960	3296	3256	2752	2336	1920	1536	612.0
FCP 15	7320	6120	6100	4960	4920	4880	4840	4000	3960	3344	2864	2368	1904	732.0
FCP 15	8640	7320	7300	5920	5880	5840	5800	4640	4600	3808	3264	2704	2208	864.0
FCP 15	10080	8640	8620	7040	7000	6960	6920	5536	5496	4576	3968	3312	2752	1008.0
FCP 15	11640	10080	10060	8160	8120	8080	8040	6528	6488	5440	4768	4048	3344	1164.0
FCP 15	13320	11640	11620	9440	9400	9360	9320	7616	7576	6352	5616	4816	3904	1332.0
FCP 15	15120	13320	13300	10880	10840	10800	10760	8800	8760	7344	6544	5664	4608	1512.0
FCP 15	17040	15120	15100	12480	12440	12400	12360	10080	10040	8432	7568	6608	5472	1704.0
FCP 15	19080	17040	17020	14240	14200	14160	14120	11520	11480	9600	8672	7632	6496	1908.0
FCP 15	21240	19080	19060	16160	16120	16080	16040	13120	13080	10976	10000	8896	7712	2124.0
FCP 15	23520	21240	21220	18240	18200	18160	18120	14880	14840	12512	11488	10304	8928	2352.0
FCP 15	25920	23520	23500	20480	20440	20400	20360	16800	16760	14144	13056	11808	10304	2592.0
FCP 15	28440	25920	25920	22880	22840	22800	22760	18880	18840	15776	14624	13344	11808	2844.0
FCP 15	31080	28440	28460	26480	26440	26400	26360	21120	21080	17600	16400	15008	13344	3108.0
FCP 15	33840	31080	31100	29280	29240	29200	29160	23040	23000	19040	17800	16304	14800	3384.0
FCP 15	36720	33840	33860	32320	32280	32240	32200	25120	25080	20640	19360	17808	16304	3672.0
FCP 15	39720	36720	36740	35840	35800	35760	35720	28320	28280	23360	22040	20400	18800	3972.0
FCP 15	42840	39720	39760	39440	39400	39360	39320	31680	31640	26240	24880	23040	21300	4284.0
FCP 15	46080	42840	42880	42720	42680	42640	42600	35360	35320	29120	27680	25600	23800	4608.0
FCP 15	49440	46080	46120	46080	46040	46000	45960	39360	39320	32320	30720	28500	26300	4944.0
FCP 15	52920	49440	49480	49440	49400	49360	49320	43680	43640	35840	34160	31800	29500	5292.0
FCP 15	56520	52920	52960	52920	52880	52840	52800	48320	48280	39520	37720	35200	33000	5652.0
FCP 15	60240	56520	56580	56540	56500	56460	56420	53280	53240	43520	41600	38900	37000	6024.0
FCP 15	64080	60240	60300	60260	60220	60180	60140	59040	59000	48640	46560	43700	41500	6408.0
FCP 15	68040	64080	64140	64100	64060	64020	63980	62880	62840	53760	51520	48500	46000	6804.0
FCP 15	72120	68040	68180	68140	68100	68060	68020	66960	66920	57760	55440	52300	50000	7212.0
FCP 15	76320	72120	72300	72260	72220	72180	72140	71040	71000	60640	58240	54900	52800	7632.0
FCP 15	80640	76320	76500	76460	76420	76380	76340	75240	75200	63840	61360	57900	56000	8064.0
FCP 15	85080	80640	80840	80800	80760	80720	80680	79584	79544	67520	64960	61400	59800	8508.0
FCP 15	89640	85080	85300	85260	85220	85180	85140	84048	84008	71200	68560	64900	63600	8964.0
FCP 15	94320	89640	89660	89620	89580	89540	89500	88416	88376	74880	72160	68400	67400	9432.0
FCP 15	99120	94320	94380	94340	94300	94260	94220	93136	93096	78560	75760	71900	71200	9912.0
FCP 15	104040	99120	99180	99140	99100	99060	99020	97936	97896	82240	79360	75400	75000	10404.0
FCP 15	109080	104040	104140	104100	104060	104020	103980	102896	102856	85920	82960	78900	78800	10908.0
FCP 15	114240	109080	109200	109160	109120	109080	109040	107952	107912	89600	86560	82500	82600	11424.0
FCP 15	119520	114240	114360	114320	114280	114240	114200	113112	113072	93280	90160	86000	86000	11952.0
FCP 15	124920	119520	119660	119620	119580	119540	119500	118416	118376	96960	93760	89600	89600	12492.0
FCP 15	130440	124920	125080	125040	125000	124960	124920	123832	123792	100640	97360	93200	93200	13044.0
FCP 15	136080	130440	130600	130560	130520	130480	130440	129352	129312	104320	100960	96800	96800	13608.0
FCP 15	141840	136080	136240	136200	136160	136120	136080	135000	134960	108000	104560	100400	100400	14184.0
FCP 15	147720	141840	141980	141940	141900	141860	141820	140736	140696	111680	108160	104000	104000	14772.0
FCP 15	153720	147720	147880	147840	147800	147760	147720	146632	146592	115360	111760	107600	107600	15372.0
FCP 15	159840	153720	153900	153860	153820	153780	153740	152656	152616	119040	115360	111200	111200	15984.0
FCP 15	166080	159840	160020	160000	159980	159960	159940	158856	158816	122720	118960	114800	114800	16608.0
FCP 15	172440	166080	166280	166260	166240	166220	166200	165112	165072	126400	122560	118400	118400	17244.0
FCP 15	178920	172440	172680	172660	172640	172620	172600	171512	171472	130080	126160	122000	122000	17892.0
FCP 15	185520	178920	179160	179140	179120	179100	179080	178000	177960	133760	129760	125600	125600	18552.0
FCP 15	192240	185520	185480	185460	185440	185420	185400	184312	184272	137440	133360	129200	129200	19224.0
FCP 15	199080	192240	192240	192220	192200	192180	192160	191072	191032	141120	137040	132800	132800	19908.0
FCP 15	206040	199080	199100	199080	199060	199040	199020	197936	197896	144800	140640	136400	136400	20604.0
FCP 15	213120	206040	206160	206140	206120	206100	206080	205000	204960	148480	144240	140000	140000	21312.0
FCP 15	220320	213120	213300	213280	213260	213240	213220	212136	212096	152160	147840	143600	143600	22032.0
FCP 15	227640	220320	220500	220480	220460	220440	220420	219336	219296	155840	151440	147200	147200	22764.0
FCP 15	235080	227640	227840	227820	227800	227780	227760	226672	226632	159520	155040	150800	150800	23508.0
FCP 15	242640	235080	235260	235240	235220	235200	235180	234096	234056	163200	158640	154400	154400	24264.0
FCP 15	250320	242640	242780	242760	242740	242720	242700	241616	241576	166880	162240	158000	158000	25032.0
FCP 15	258120	250320	250480	250460	250440	250420	250400	249312	249272	170560	165840	161600	161600	25812.0
FCP 15	266040	258120	258300	258280	258260	258240	258220	257136	257096	174240	169440	165200	165200	26604.0
FCP 15	274080	266040	266260	266240	266220	266200	266180	265096	265056	177920	173040	168800	168800	27408.0
FCP 15	282240	274080	274460	274440	274420	274400	274380	273296	273256	181600	176640	172400	172400	28224.0
FCP 15	290520	282240	282600	282580	282560	282540	282520	281432	281392	185280	180240	176000	176000	29052.0
FCP 15	298920	290520	290900	290880	290860	290840	290820	289736	289696	18				

Flat Plate Cells: Type FCP & FHP

Constant Current Discharge Rates at 25° Centigrade

Current (in amps) to 1.65 - 1.60 Volts per Cell

Cell Type	5 min	10 min	15 min	20 min	30 min	45 min	1 hour	2 hour	3 hour	5 hour	6 hour	8 hour	10 hour	Volts/Cell
FCP 5	89.3	81.0	70.8	63.0	49.4	40.9	32.0	26.2	23.0	19.7	9.4	7.5	6.4	1.65
FCP 7	146	127	106	91.3	74.4	61.2	48.0	38.4	32.0	25.0	16.1	14.1	11.3	
FCP 9	191	167	142	120	98.8	81.4	64.0	48.0	38.0	27.4	23.8	15.1	12.8	
FCP 11	235	205	175	150	125	102	80.0	58.0	45.0	32.4	28.8	18.8	16.0	
FCP 13	280	245	210	180	147	122	96.0	68.0	52.0	36.8	32.4	20.8	18.0	
FCP 15	324	275	240	208	171	142	112	77.0	58.8	37.8	32.8	20.8	20.4	
FCP 17	370	314	280	247	194	161	128	88.2	67.2	42.8	37.5	23.1	25.6	
FCP 19	426	355	315	269	215	181	144	97.3	76.2	48.2	42.2	25.9	28.8	
FCP 21	482	396	347	291	231	197	160	108	84.2	52.2	46.2	28.8	32.4	
FCP 23	538	421	361	305	245	201	176	112	84.2	52.8	51.8	41.4	35.2	
FCP 25	594	452	389	327	269	221	192	120	91.8	64.2	56.2	46.2	38.4	
FCP 27	650	494	426	360	305	250	208	132	96.3	69.8	61.3	49.0	41.6	
FCP 29	706	538	460	400	336	280	224	142	107	78.2	67.2	52.8	44.8	
FCP 31	762	582	498	426	364	300	240	152	115	85.2	75.2	58.8	48.0	
FCP 33	818	626	527	450	400	340	272	172	130	91.0	79.2	64.2	54.4	
FCP 35	874	670	567	487	430	360	288	184	138	96.0	84.4	67.8	57.6	
FCP 37	930	714	607	515	450	360	288	184	138	96.0	84.4	67.8	57.6	
FCP 39	986	758	647	552	478	398	308	198	148	105	93.8	75.4	64.0	
FCP 41	1042	802	687	589	498	418	328	212	161	112	98.2	79.4	67.2	
FHP 15	321	302	270	234	185	158	124	98	82	58	48	32	28	
FHP 17	353	331	297	257	202	172	132	104	88	64	52	36	32	
FHP 19	384	357	320	275	217	187	144	112	96	72	60	40	36	
FHP 21	416	387	345	297	232	197	156	120	104	80	68	44	40	
FHP 23	447	415	375	324	252	212	168	128	112	92	76	48	44	
FHP 25	479	444	400	344	272	227	180	136	120	100	84	52	48	
FHP 27	510	473	425	364	292	242	192	144	128	108	92	56	52	
FHP 29	542	501	448	384	312	257	204	152	136	116	100	60	56	
FHP 31	573	529	473	404	332	272	216	160	144	124	108	64	60	
FHP 33	605	567	503	424	352	292	228	168	152	132	116	68	64	
FHP 35	636	595	527	444	372	312	240	176	160	140	124	72	68	
FHP 37	668	623	547	464	392	332	252	184	168	148	132	76	72	
FHP 39	699	651	567	484	412	352	264	192	176	156	140	80	76	
FHP 41	731	679	587	504	432	372	276	200	184	164	148	84	80	
FHP 43	762	707	607	524	452	392	288	208	192	172	156	88	84	
FHP 45	794	735	627	544	472	412	300	216	200	180	164	92	88	
FHP 47	825	763	647	564	492	432	312	224	208	188	172	96	92	
FHP 49	857	791	667	584	512	452	324	232	216	196	180	100	96	
FHP 51	888	819	687	604	532	472	336	240	224	204	188	104	100	
FHP 53	920	847	707	624	552	492	348	248	232	212	200	108	104	
FHP 55	951	875	727	644	572	512	360	256	240	220	208	112	108	
FHP 57	983	903	747	664	592	532	372	264	248	228	216	116	112	
FHP 59	1014	931	767	684	612	552	384	272	256	236	224	120	116	
FHP 61	1046	959	787	704	632	572	396	280	264	244	232	124	120	
FHP 63	1077	987	807	724	652	592	408	288	272	252	240	128	124	
FHP 65	1109	1015	827	744	672	612	420	296	280	260	248	132	128	
FHP 67	1140	1043	847	764	692	632	432	304	288	268	256	136	132	
FHP 69	1172	1071	867	784	712	652	444	312	296	276	264	140	136	
FHP 71	1203	1100	887	804	732	672	456	320	304	284	272	144	140	
FHP 73	1235	1127	907	824	752	692	468	328	312	292	280	148	144	
FHP 75	1266	1155	927	844	772	712	480	336	320	300	288	152	148	
FHP 77	1298	1183	947	864	792	732	492	344	328	308	296	156	152	
FHP 79	1329	1211	967	884	812	752	504	352	336	316	304	160	156	
FHP 81	1361	1239	987	904	832	772	516	360	344	324	312	164	160	
FHP 83	1392	1267	1007	924	852	792	528	368	352	332	320	168	164	
FHP 85	1424	1295	1027	944	872	812	540	376	360	340	328	172	168	
FHP 87	1455	1323	1047	964	892	832	552	384	368	348	336	176	172	
FHP 89	1487	1351	1067	984	912	852	564	392	376	356	344	180	176	
FHP 91	1518	1379	1087	1004	932	872	576	400	384	364	352	184	180	
FHP 93	1550	1407	1107	1024	952	892	588	408	392	372	360	188	184	
FHP 95	1581	1435	1127	1044	972	912	600	416	400	380	368	192	188	
FHP 97	1613	1463	1147	1064	992	932	612	424	408	388	376	196	192	
FHP 99	1644	1491	1167	1084	1012	952	624	432	416	396	384	200	196	
FHP 101	1676	1519	1187	1104	1032	972	636	440	424	404	392	204	200	
FHP 103	1707	1547	1207	1124	1052	992	648	448	432	412	400	208	204	
FHP 105	1739	1575	1227	1144	1072	1012	660	456	440	420	408	212	208	
FHP 107	1770	1603	1247	1164	1092	1032	672	464	448	428	416	216	212	
FHP 109	1802	1631	1267	1184	1112	1052	684	472	456	436	424	220	216	
FHP 111	1833	1659	1287	1204	1132	1072	696	480	464	444	432	224	220	
FHP 113	1865	1687	1307	1224	1152	1092	708	488	472	452	440	228	224	
FHP 115	1896	1715	1327	1244	1172	1112	720	496	480	460	448	232	228	
FHP 117	1928	1743	1347	1264	1192	1132	732	504	488	468	456	236	232	
FHP 119	1959	1771	1367	1284	1212	1152	744	512	496	476	464	240	236	
FHP 121	1991	1800	1387	1304	1232	1172	756	520	504	484	472	244	240	
FHP 123	2022	1827	1407	1324	1252	1192	768	528	512	492	480	248	244	
FHP 125	2054	1855	1427	1344	1272	1212	780	536	520	500	488	252	248	
FHP 127	2085	1883	1447	1364	1292	1232	792	544	528	508	496	256	252	
FHP 129	2117	1911	1467	1384	1312	1252	804	552	536	516	504	260	256	
FHP 131	2148	1939	1487	1404	1332	1272	816	560	544	524	512	264	260	
FHP 133	2180	1967	1507	1424	1352	1292	828	568	552	532	520	268	264	
FHP 135	2211	1995	1527	1444	1372	1312	840	576	560	540	528	272	268	
FHP 137	2243	2023	1547	1464	1392	1332	852	584	568	548	536	276	272	
FHP 139	2274	2051	1567	1484	1412	1352	864	592	576	556	544	280	276	
FHP 141	2306	2079	1587	1504	1432	1372	876	600	584	564	552	284	280	
FHP 143	2337	2107	1607	1524	1452	1392	888	608	592	572	560	288	284	
FHP 145	2369	2135	1627	1544	1472	1412	900	616	600	580	568	292	288	
FHP 147	2400	2163	1647	1564	1492	1432	912	624	608	588	576	296	292	
FHP 149	2432	2191	1667	1584	1512	1452	924	632	616	596	584	300	296	
FHP 151	2463	2219	1687	1604	1532	1472	936	640	624	604	592	304	300	
FHP 153	2495	2247	1707	1624	1552	1492	948	648	632	612	600	308	304	
FHP 155	2526	2275	1727	1644	1572	1512	960	656	640	620	608	312	308	
FHP 157	2558	2303	1747	1664	1592	1532	972	664	648	628	616	316	312	
FHP 159	2589	2331	1767	1684	1612	1552	984	672	656	636	624	320	316	
FHP 161	2621	2359	1787	1704	1632	1572	996	680	664	644	632	324	320	
FHP 163	2652	2387	1807	1724	1652	1592	1008	688	672	652	640	328	324	
FHP 165	2684	2415	1827	1744	1672	1612	1020	696	680	660	648	332	328	
FHP 167	2715	2443	1847	1764	1692	1632	1032	704	688	668	656	336	332	
FHP 169	2747	2471	1867	1784	1712	1652	1044	712	696	676	664	340	336	
FHP 171	2778	2500	1887	1804	1732	1672	1056	720	704	684	672	344	340	
FHP 173	2810	2527	1907	1824	1752	1692	1068							

