

Saft. Rechargeable Battery Systems handbook



Spring 2004



1

Saft, the specialist in Rechargeable Battery Systems

Saft advantages and performances

Saft, a worldwide leader in the design, development and manufacturing of Rechargeable Battery Systems, has developed a broad range of high performance nickel-cadmium and nickel-metal hydride cells to meet the requirements of a wide range of applications. Saft's full range of cells and battery pack solutions use both proven and innovative technologies for exceptional performance tailored to your specific needs. For the best and latest rechargeable cylindrical cells in a wide range of capacities, look no further than Saft.

Saft batteries offer exceptional performances:

- Constant voltage during discharge
- High power
- A broad temperature range (-40°C to +65°C)
- A lifetime often outlasting the equipment they serve
- Zero maintenance
- Extremely high reliability
- Long cycle life (over 500 charge/discharge cycles)
- Excellent long term storage

Saft factories are certified ISO 9001.



Saft, total quality and respect for the environment

Of course, the use of rechargeable is an environment-friendly act since the batteries can be used over and over again. In addition, Saft is extremely sensitive to protecting nature through the battery's entire life cycle. Saft factories strictly adhere to environmental regulations concerning air, water, ground and solid-waste standards. When batteries have given their best through existing national collection and recycling organisms (i.e. RBRC in US, S.C.R.A. in France, and others in European countries), Saft offers a collection and treatment service to recycle Ni-Cd and Ni-MH batteries safely and efficiently. Saft also operates a recycling plant in Oskarshamn (Sweden).



Safety instructions for handling and use

- Never cause a short circuit between battery's positive and negative poles.
- Do not disassemble cells and batteries.
- Do not incinerate or overheat.
- Do not clean cells and batteries with water or corrosive agents.
- Never use a leaking or externally damaged battery.
- Keep cells and batteries away from children to avoid them being accidentally swallowed
- Collect used cells and batteries for recycling to protect environment.

You can also consult:

www.collectnicad.org

In other countries without organizations, Saft can provide you information.

The right battery for every application

Saft meets all your needs

Saft's solutions are customer-driven. Our standard batteries and special power assemblies are engineered to meet the growing power needs for high-power and high-energy battery solutions.

Saft batteries can be found in:

Mobility

Includes e-bikes, e-scooters and other personal electric vehicles.

Professional appliances

Includes handheld terminals, medical electronics, lighting equipment, portable instruments and professional notebook computers.

Security devices

Includes emergency lighting units, back-up systems, UPS and alarms.

Power tools

Includes professional cordless drills, sanders, screw-drivers, agricultural and gardening equipment.

Communications

Includes cellular and cordless phones, Personal Communication systems (PCs), private mobile radios and military equipment.

Audio/video

Includes, professional video equipment, camcorders, portable TVs, CD players and personal stereos and digital cameras.

Home appliances

Includes cordless vacuum cleaners, shavers, tooth-brushes, and more.

Battery powered hobbies

Includes radio-controlled cars, boats, planes, electronic games and walkmans.



VR/VRE	✓	✓	✓	✓	✓		✓	
VE/VSE		✓					✓	✓
VH/VHT	✓	✓	✓	✓	✓	✓	✓	✓
VT			✓					

Saft, the expert in battery pack assembly

A world class worldwide battery manufacturer

Saft's sole business is the design and manufacturing of high end battery and energy systems. Saft is an international company with nearly 80 years of experience in cell and battery design and production. Saft offers a partnership between your product design team and our battery development teams. By combining our strengths, we can provide concept, design and delivery that shorten your time to market, with a portable power system custom-designed for your product's unique demands.

Generate efficient solutions

Through Saft's teams of experts, your product and its energy system are developed simultaneously, so you avoid expensive design problems and delays that could hold your product back in today's fast-moving marketplace. Quick sample turnaround and rigorous testing enable you to assess the performance of both your product and its energy system. Saft's up-to-date service network efficiently coordinates every step of production and delivery. At every step throughout the product development process, the Saft team helps you streamline your product design and accelerate its time to market.

Design and other considerations

The basic building block of any nickel-cadmium or nickel-metal hydride battery configuration is the 1.2V sealed cell, which can be any of the cylindrical shapes described below. A typical 12 volt battery, for example, will consist of 10 cells connected in a series to give $1.2 \times 10 = 12$ volts.

In the simplest application, therefore, a knowledge of the voltage and current required and the duration of the discharge will provide the initial selection.

Configuration

After electrical considerations, you must plan the battery pack itself in terms of space, protection and electrical connection. When planning the battery pack, you should consider the following:

- The number of cells needed.
- Physical arrangement in available space.
- The outer case or wrap, which provides both "packaging" for the battery and protection for the cells.
- Arrangement and type of materials needed for electrical connection to the device.

Standard to custom-designed arrangements

Standard Saft battery packs include shrink wrapped configurations from 1.2 to 36 volts, or more. Packaging with adhesives, special insulation materials, or the inclusion of battery management devices (charge control, discharge control, fuel gauge...) are also available.

EXAMPLES OF STANDARD ASSEMBLIES:

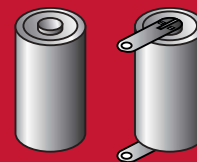

CELLS Saft can offer several types of terminals for its "standard assembly" packs. The most common models are automatically welded on the same side.



SIDE-BY-SIDE For cylindrical cells, Saft uses single cells separated by sleeves or plastic labels. For some applications, Saft can offer cardboard tube insulation.

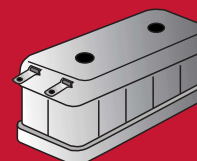

FLANGE

Side-by-side or stick batteries can be assembled into flanges, PVC shrink-wrapping, or plastic casings.



STICK Saft also manufactures stick assemblies arranged in series connected by cups. Insulation is guaranteed either by sleeve or cardboard tube.

CYLINDRICAL CELLS

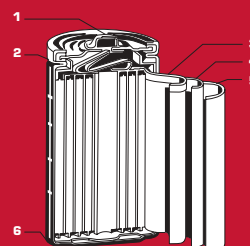

Cutaway of a cylindrical cell

1. Safety vent
2. Seal
3. Positive plate
4. Separator
5. Negative plate
6. Nickel-plate steel case

Ni-MH



SUPER HIGH ENERGY VH series

Saft's range of Ni-MH cylindrical cells is being extended.

Manufactured for use in high capacity, these cells are designed for portable applications which demand fast charge and discharge over an extended lifetime. The VH Cs, VH D and VH F specially target

cordless power tools applications, e-bikes and personal electric vehicles and professional appliances.

The latest VHT range has been designed to accept high temperature requirements (up to 40°C) for a minimum of 4 years life time, such as in emergency lighting equipment.

Saft type	IEC Capacity at 0.2C rate		Standard charge (**)	Quick or fast charge		Internal impedance m Ω	Max. Dimensions for bare cells		Approx weight (g)	
	Nominal voltage: 1.2 volts/cell	Typical (mAh)	Minimum (mAh)	Current (mA)	Max current (mA)		Time (h)	Diameter (mm)		Height (mm)
VH										
VH AAA 700*		750	700	70	700	~1	22	10.1	44.3	12
VH AA*		1300	1200	120	1200	~1	21	14.0	49.2	25
VH AA 1500*		1500	1400	140	1400	~1	20	14.0	49.2	26
VH AA 1700		1700	1600	160	1600	~1	25	14.0	49.2	25
VH Cs 3200		3200	3000	320	1500	~2-3	5	22.0	42.3	59
VH D		8500	8000	850	4000	~2-3	4	32.3	58.6	160
VH D 9500		9500	9000	950	4000	~2-3	4	32.3	58.6	160
VH F 15000		15000	14000	1500	4000	~3-4	4	32.3	89.1	250
VHT AA		1150	1100	110	-	-	18	14.0	49.2	26
VHT Cs		2200	2000	200	-	-	5.3	22.0	42.4	59
UNDER DEVELOPMENT										
VH D 10000		10000	9500	1000	5000	~2-3	4	32.3	58.6	160
VH F 16000		16000	15000	1600	4000	~3-4	4	32.3	89.1	250
VHT F		11000	10000	1000	-	-	4	32.3	89.1	250

* Those cells, VH AAA 700, VH AA and VH AA 1500, are also available with a high top. Diameter is similar. The projection of the top is 1.7 ±0.2 mm, the flat area diameter is 4.0 mm, and the total height of the cell is 49.9 ±0.3 mm.

(**) Standard charge is 16 hours.

Ni-Cd

STANDARD VR and VRE series

Engineered for cycling applications, Saft's standard series can be used for a wide range of applications. In addition, the VRE series is well-adapted for applications requiring a permanent charge (C/20 to C/15)

at temperatures of up to +35°C. These two standard series have been produced in hundreds of millions of units for many years, with a high level of reliability. They offer an excellent cost/performance ratio.



Saft type	IEC Capacity at 0.2C rate		Standard charge (⚡)	Quick or fast charge		Internal impedance m Ω	Max. Dimensions for bare cells		Approx. weight (g)	
	Nominal voltage: 1.2 volt/cell	Typical (mAh)	Minimum (mAh)	Current (mA)	Current (mA)		Time (h)	Diameter (mm)		Height (mm)
VR VR 2/3 D		2850	2500	250	2500	~1	3.3	32.4	43.3	103
VR 4 D		4500	4000	400	4000	~1	3.1	32.4	60.3	145
VR 7 FL		7700	7000	700	3500	~2.5	2.7	32.4	89.1	228
VR 10 SF		11600	10000	1000	-	-	2.0	41.2	89.0	390
VRE VRE 1/3 AA		145	130	13	130	~1	48	13.6	16.8	7
VRE 1/2 AA		350	300	30	300	~1	30	14.0	29.8	12
VRE AA 600 ⁽¹⁾		700	600	60	600	~1	16	14.0	49.2	20
VRE AA 700 ⁽¹⁾		780	700	70	700	~1	14	14.0	49.2	21
VRE Cs		1450	1300	130	1300	~1	6	22.2	42.2	46
VRE Cs 1500		1500	1400	140	1400	~1	6	22.2	42.2	46
VRE Cs 1800		1800	1700	170	1700	~1	5	22.2	42.2	50
VRE C		2550	2300	230	2300	~1	8	25.3	49.5	77
VRE 1/2 D		2550	2400	240	2400	~1	18	32.3	36.8	82
VRE D		5100	4500	450	4500	~1	4	32.3	58.6	151
VRE D 5500		5500	5000	500	5000	~1	4	32.3	58.6	151
VRE F		8800	8000	800	8000	~1	4	32.15	88.8	208

(1) Those cells, VRE AA 600 and VRE AA 700 are also available with a high top. Diameter is similar. The projection of the top is 1.7 ±0.2 mm, the flat area diameter is 4.0 mm, and the total height of the cell 49.9 ±0.3 mm. With a high top, is also available for cordless and DECT phones for continuous charge: VRE AAH 700C. Please consult Saft.

(2) This cell, VTD 70, is also available with a low top. The projection of the top is 1.4mm +/-0.4 and the total height is 58.0 +/- 0.4.

(3) VTD, VTF: up to 40°C temperature environment. VTD 70, VTF 70: up to 50°C temperature environment. VTD U: up to 55°C temperature environment.

(4) Standard charge is 16 hours.

(5) This cell, VSE AA, is also available with a high top. Diameter is similar. The projection of the top is 1.7 ±0.2mm, the flat area diameter is 4.0mm, and the total height of the cell 49.9 ±0.3mm



HIGH TEMPERATURE VT series

These cells accept a permanent charge (C/20 to C/15) for a minimum of 4 years in high-temperature environment (up to +40°C) such as security emergency equipment. Improved

versions of the cells, such as the VTCs 1500 U and VTD 70, can withstand a constant temperature of up to +55°C with a similar lifetime when permanently charged.

Saft type	IEC Capacity at 0.2C rate		Standard charge (***)	Permanent charge		Internal impedance m Ω	Max. Dimensions for bare cells		Approx. weight (g)	
	Nominal voltage: 1.2 volts/cell	Typical (mAh)	Minimum (mAh)	Current (mA)	Current (mA)		Time (h)	Diameter (mm)		Height (mm)
VT VT AA		700	600	60	30	-	28	14.0	50.2	20
VT Cs		1350	1200	120	60	-	12	22.2	42.2	45
VT Cs 1500		1650	1500	150	75	-	8	22.2	42.2	48
VT Cs 1600		1750	1600	160	80	-	7	22.2	42.2	49
VT C		2500	2200	220	110	-	14	25.3	49.5	75
VT C 2500		2700	2500	250	125	-	14	25.3	49.5	75
VT 1/2 D		2500	2200	220	110	-	10	32.3	36.8	80
VT D ⁽³⁾		4300	4000	400	200	-	7	32.3	60.3	132
VT D 70 ⁽²⁾⁽³⁾		4500	4000	400	200	-	6	32.4	60.3	134
VT D U ⁽³⁾		4700	4100	400	200	-	6	32.3	58.4	136
VT F ⁽³⁾		7500	7000	700	350	-	5	32.4	91.1	210
VT F 70 ⁽³⁾		7700	7000	700	350	-	5	32.4	89.5	210

UNDER DEVELOPMENT

VT Cs 1500U	1650	1500	150	75	-	8	22.2	42.2	48
-------------	------	------	-----	----	---	---	------	------	----



HIGH ENERGY VE and VSE series

With the VE series, Saft upgrades its standard technology: it boosts capacity by 10 to 15% without increasing volume, while at the same

time maintaining performance levels. The VSE series uses advanced nickel foam electrode technology providing both fast charge and higher capacity meeting the needs of today's light and compact portable equipment.

Saft type	IEC Capacity at 0.2C rate		Standard charge (***)	Quick or fast charge		Internal impedance m Ω	Max. Dimensions for bare cells		Approx. weight (g)	
	Nominal voltage: 1.2 volts/cell	Typical (mAh)	Minimum (mAh)	Current (mA)	Current (mA)		Time (h)	Diameter (mm)		Height (mm)
VE VE 2/3 A		670	600	60	600	~1	25	16.7	28.0	18
VE 4/5 A		1050	1000	100	1200	~1	21	16.7	42.3	27
VE Cs		1560	1400	140	1680	~1	5	22.2	42.2	48
VE C		2400	2200	220	2200	~1	5	25.3	49.5	75
VE D		5100	4500	450	4500	~1	2.6	32.4	58.8	150
VSE VSE AA ⁽⁵⁾		980	940	94	940	~1	16	14.0	49.2	22
VSE 4/5 A		1300	1200	120	1200	~1	17	16.7	42.3	28

SAFT RECHARGEABLE BATTERY SYSTEMS SALES NETWORK

FRANCE Headquarters
12 rue Sadi Carnot - 93170 Bagnolet
Tel: +33 (0)1 49 93 19 18
Fax: +33 (0)1 49 93 19 68
E-mail: rbs.info@saftbatteries.com

AUSTRALIA Saft Australia Pty Ltd
Unit 18, 167 Prospect Highway
Seven Hills NSW 2147
Tel: (61-2) 9674 0700 - Fax: (61-2) 9620 9955
E-mail: wayne.pitt@saftbatteries.com.au

CHINA Saft Shanghai
Alcatel Telecom Equipment Co, Ltd
39# N°275, Basheng Road,
Waigaoqiao Free Trade Zone
Shanghai 200131
Tel: +86 21 58666405
Fax: +86 21 58666403
Email: c.zhang@saft.com.hk

GERMANY Saft Batterien GmbH
Behringstrasse 13 - D-63814 Mainaschaff
Tel: +49 6021 707 70 - Fax: +49 6021 707 85
E-mail: joachim.hennecke@saftbatteries.com

HONG-KONG Saft Hong Kong Ltd
Unit 1106-9, 11/F, - Westin Centre
26 Hung to road, - Kwun Tong - Kowloon
Tel: (852) 2796 9932 Fax: (852) 2798 0619
E-mail: ivan.lam@saft.com.hk

ITALY Saft Batterie Italia S.r.l
Palazzo Cimabue
Centro Direzionale Milano Oltre
Via Cassanese 224 - 20090 Segrate (Milano)
Tel: +39 02 89 28 07 47
Fax: +39 02 89 28 07 62
Email: valerio.telo@saftbatteries.com

NETHERLANDS Saft Batteries B.V
Crown Business Center, unit B32
A. Hofmanweg 5A - 2031 BH Haarlem
Tel: (31) 23 7505 720
Fax: (31) 23 7505 726
E-mail: frans.mennings@saftbatteries.com

NORWAY Saft AS
Grini Naeringspark 1. - 1361 Osteraa
Tel: (47) 6716 4163 - Fax: (47) 6716 4170
E-mail: aage.arnesen@saftbatteries.com

RUSSIAN FEDERATION Saft
Bolshaya Yakimanka, 42, b.2 - 117049 Moscow
Tel: 7 (095) 937 09 67
Fax: 7 (095) 937 09 06
E-mail: dmitry.lozine@alcatel.ru

SINGAPORE Saft Batteries Pte Ltd
54 Genting Lane - #03-02 Hiang Kie Complex II
Singapore 349562
Tel: (65) 68465 700 - Fax: (65) 67466 772
E-mail: colin.chan@saft.com.sg

SPAIN/PORTUGAL Saft Baterias S.L.
Avenida Fuente Nueva 12 - Nave 15
San Sebastian de los Reyes 28700 (Madrid)
Tel: (34) 916 593 480
Fax: (34) 916 593 490
E-mail: joaquin.chacon@saftbatteries.com

SWEDEN Saft AB
Jungnergatan - Box 709
SE - 572 28 Oskarshamn
Tel: (46) 491 68000 - Fax: (46) 491 68085
E-mail: helena.drehmer@saftbatteries.com

UNITED KINGDOM Saft Ltd
6 th floor Westgate house
Westgate Harlow - Essex - CM 20 1 JN
Tel: (44) 12 79 77 25 50
Fax: (44) 12 79 42 09 09
E-mail: dave.pattison@saftbatteries.com

USA Saft America Inc.
313 Crescent Street - Valdese, NC 28690
Tel: (828) 879 5010 - Fax: (828) 879 3981
E-mail: pbd.sales@saftbatteries.com

CUSTOMER SERVICE
Tel.: (828) 879-5014
Fax: (828) 879-3981

SAFT RECHARGEABLE BATTERY SYSTEMS AUTHORIZED SALES AGENTS AND DISTRIBUTORS

ARGENTINA CH Sistemas Electronicos
2758 Av. Cordoba - 1187 Buenos Aires
Tel: (54) 1 962 16 25 - Fax: (54) 1 962 16 27
E-mail: info@ch-sistemas.com.ar

Probattery baires full trading
Paz Soldán 4960 C1427DSF - Buenos Aires
Tel: (54-11) 45 14 68 68
Fax: (54-11) 45 14 68 66
E-mail: gfreund@probattery.com.ar

AUSTRIA SED
Gorkistrasse 16 - 1230 Wien
Tel: (43-1) 616 03 03 27
Fax: (43-1) 616 03 03 6
E-mail: sed@vienna.at

BELGIUM Helpelec
Avenue du Couronnement, 11 B
1200 Brussels
Tel: (32-2) 7 62 33 38
Fax: (32-2) 7 62 37 01
E-mail: info@helpelec.be

BRAZIL Barasch Sylmar
R. Guaicurus, 345 - LAPA Sao Paulo
SP 05033-000
Tel: (11) 3864 63 66 - Fax: (11) 3864 63 66
E-mail: barasch@uol.com.br

CZECH REPUBLIC Bateria Slany
Netovicka 875 - 27401 Slany
Tel: (420-314) 522 849
Fax: (420-314) 522 868
E-mail: george@bateria.cz

DENMARK Scansupply A/S
Bloken 44 - DK 3460 - Birkerød
Tel: (45) 45 82 50 90 - Fax: (45) 45 82 54 40
E-mail: flemming@scansupply.dk

FINLAND Hansabattery OY
Ruukintie 20 C - 02320 - ESPOO
Tel: (358-9) 2606 5290
Fax: (358-9) 2606 5299
E-mail: hans.sandstrom@hansabattery.fi

HUNGARY Kapacitas
H-1115 Budapest - Szentpétery u.24-26
Tel: (36-1) 463 0880 - Fax: (36-1) 463 0899
E-mail: varga.zsigmond@kapacitas.hu

ISRAEL ASR
P.O.B 9270 - 61091 Tel Aviv
Tel: (972) (3) 5015322
Fax: (972) (3) 5031986
E-mail: asr@isdnet.net.il

JAPAN Sumitomo Corporation
Triton Square Office Tower Z 22F
1-8-12, Harumi, Chuo-Ku - Tokyo, 104-6222
Tel: (81-3) 5144 9081 - Fax: (81-3) 5144 9267
E-mail: Haruyuki.Tabuchi@sumitomo.co.jp

KOREA Cellcom Co. Ltd.
195-42 Anyang 7-dong - Manan-Ku
Anyang-city Kyunggi-do
Tel: (82) 31 441 1134 - Fax: (82) 31 441 1139
E-mail: skci@saftkorea.com

POLAND Wamtechnik
19, Czajewicza street - 5-500 Piaseczno
Tel: (48) 22 75 02 142
Fax: (48) 22 75 02 139
E-mail: pwlodarczyk@wamtechnik.com.pl

ROMANIA Sprinter 2000 SA
Brasov 2200, - Calea Feldioarei, nr 60
Tel: (40) 268 47 23 33
Fax: (40) 268 47 23 34
E-mail: sprinter@deltanet.ro

SAUDI ARABIA & MIDDLE EAST
Dar Al Fursan
P.O.B 16221, Riyadh 11464
Tel: (966-1) 462 08 16 - Fax: (966-1) 462 08 16
E-mail: nader.altaher@daralfursan.com

SOUTH AFRICA Uniross Batteries Ltd
POB 28861, Carl Street,
Pretoria West - Sunny Side 0132
Tel: (27-12) 327 32 66
Fax: (27-12) 327 32 94
E-mail: sean@uniross.com

SWITZERLAND Leclanche SA
48 avenue de Grandson
01401 Yverdon-Les-Bains
Tel: (41) 24 44 72 272
Fax: (41) 24 44 72 230
E-mail: daniel.biollay@leclanche.ch

TURKEY Gestas AS
Florya is Merkezi K.2 - 34630 Sefakoy-Istanbul
Tel: (90) 212 624 52 29
Fax: (90) 212 599 30 68
E-mail: yasinsuudi@gestas-electronic.com.tr

For other countries, please send your
batteries request to:
rbs.info@saftbatteries.com

Published by the Communication Department
• Société anonyme au capital de 76 200 000 Euros
• 383 703 873 RCS Bobigny
• Photo Credit: Saft, Sachs, Ingenico, EADS, Gettyimages
• Design by KR PLUS [24080]
• Information in this document is subject to change without notice and becomes contractual only after written confirmation by Saft.
DOC. N° 11087- 2- 0404

Saft
Rechargeable Battery Systems
12 rue Sadi Carnot
93170 Bagnolet
Tel: +33 (0)1 49 93 19 18
Fax: +33 (0)1 49 93 19 68
E-mail: rbs.info@saftbatteries.com
www.saftbatteries.com



SAFT